

# Vantage Feed Center

Fast color change in a simple and easy-to-operate feed center.

Nordson's Vantage Feed Center provides all the features and benefits previously available only in fast color change system feed centers – and even more. The many features of our Vantage Feed Center include:

- Large and open design for fast and effortless color change
- Available for use on both color module and cyclone based systems
- Accommodates stainless steel round hopper (50 lb.), plastic rectangular hopper and powder box\*
- Simple and readily accessible controls for ease of use
- High pressure purge for contamination free color change
- Allows for both reclaim and virgin powder supplies

\* Powder box delivery requires both the vibratory table and local fluidizing options



Vantage Feed Center with fluidized rectangular hopper

- 1 Integrated pick-up tube mounts for Prodigy® with HDLV® manual gun systems
- 2 Simple and durable pump locking device for reliable seal and repeatable positioning of the delivery pumps
- 3 Air cylinder clamping mechanism to lock and seal lance assembly
- 4 Tapered guides for precise pump lance positioning
- 5 Level sensor for consistent powder feed level in the hopper
- 6 Easy-to-clean 15" vibratory sieve for fast color change and a contamination-free finish



Capable of delivering powder from 50 lb. stainless steel round hoppers and powder supplier's boxes

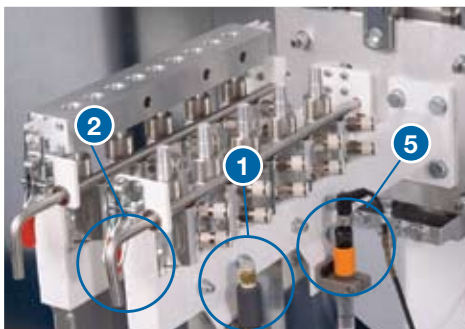

# Vantage Feed Center

## Reliable and Repeatable Performance During Application and Color Change

The Vantage Feed Center offers a variety of features that make it easy to operate. In addition, it is designed for high-performance, with many other features incorporated into the design to provide reliability and repeatability. These include:

- Twenty-seven pump capacity
- One-piece lance with nine in-line pump stations
- Free standing over-center air cylinder for smooth travel of up/down pump lance positioning
- Integrated light fixture



Solid lance assembly

## Specifications and Utility Requirements

Booth	
Rated CFM	6000
Air Consumption @ 100 PSI	15 SCFM
Exhaust Motor	5HP
Voltage (Amps):	
230/3/60	15
460/3/60	7.5
Feed Center	
Air Input Size	1-1/2" NPT
Air Consumption @ 100 PSI	45 SCFM Normal Operation 360 SCFM Maximum (Instantaneous flowrate during purge sequence)
Sieve Motor	1/3 HP
Voltage (Amps)	110/1/60 - 10

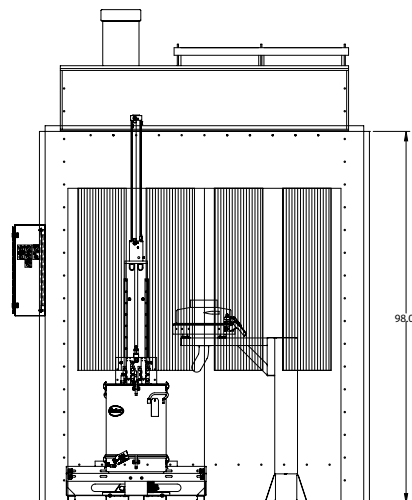
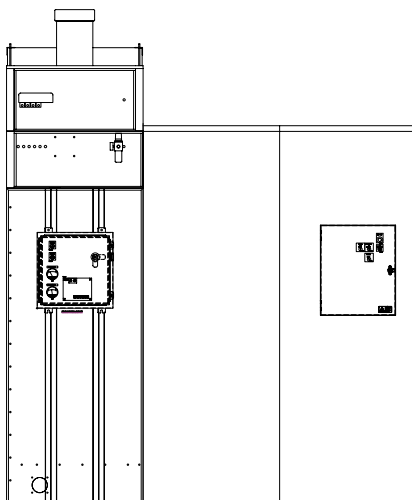
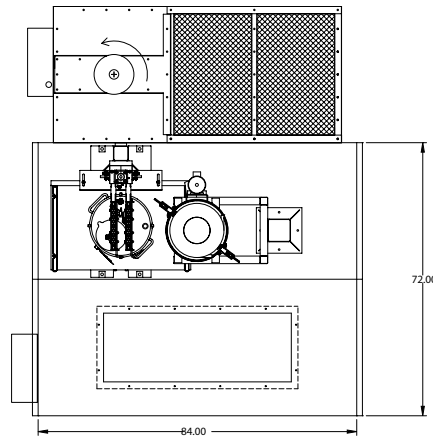

For more information, speak with your Nordson representative or contact your Nordson regional office.

### United States

Amherst, Ohio  
+1.800.626.8303 Phone  
+1.888.229.4580 Fax

### Canada

Markham, Ontario  
+1.905.475.6730 Phone  
+1.800.463.3200 Phone  
+1.905.475.8821 Fax

### Europe

Erkrath, Germany  
+49.211.9205.141 Phone  
+49.211.9252.148 Fax

### Japan

Tokyo, Japan  
+81.3.5762.2700 Phone  
+81.3.5762.2701 Fax

### Asia/Australia/ Latin America

Amherst, Ohio  
+1.440.985.4000 Phone  
24-hour message service:  
+1.440.985.4797

© 2009 Nordson Corporation  
All Rights Reserved

PWL-09-5512  
Issued 12/09